



**Ruta 40**<sup>®</sup>  
INDEPENDENT  
TRAVEL DESIGNERS



**AUSTRALIS**<sup>®</sup>  
CAPE HORN & PATAGONIA

M/V STELLA AUSTRALIS - M/V VENTUS AUSTRALIS

# Rates & Departures | Tarifas y Salidas

September 2019 - April 2020



Per informazioni e prenotazioni: Ruta40 Tour Operator - [info@ruta40.it](mailto:info@ruta40.it) - +39 011 7718046



Map for tourism related purposes. "Authorized circulation, by Resolución #185 from June 15th, 2000 of the Borders and State Limits National Direction."  
 Mapa con fines turísticos. "Autorizada su circulación, por Resolución N° 185 del 15 de junio de 2000 de la Dirección General de Fronteras y límites del Estado".

# Rates & Departures · September 2019 – April 2020

## Tarifas y Salidas · Septiembre 2019 – Abril 2020

(Per person rates based on double occupancy in US\$. / Tarifas en base doble por persona en US\$.)

Rates (4 nights)	Cabin	Promotional	Low	High
	B	1.565	1.960	2.478
A	2.122	2.620	3.177	
AA	2.228	2.731	3.337	
AAA	2.289	2.814	3.456	
AA Superior	2.680	3.333	4.067	
AAA Superior	2.850	3.531	4.274	

Rates (8 nights)	Cabin	Promotional	Low	High
	B	2.817	3.528	4.460
A	3.820	4.716	5.719	
AA	4.010	4.916	6.007	
AAA	4.120	5.065	6.221	
AA Superior	4.824	5.999	7.321	
AAA Superior	5.130	6.356	7.693	

Rates are "starting from", and only for a limited cabin stock per departure. Single rates will be applied in all types of cabins and the rate will be the 150% of the category rate. Tarifas "desde" para un stock limitado de cabinas por viaje. Tarifas single aplicará en todo tipo de cabinas y corresponderá al 150% del valor de la categoría.

### Departures / Salidas Punta Arenas - Ushuaia

#### M/V Stella Australis (4 nights)

September / Septiembre 2019		21	29		
October / Octubre	2019	7	15	23	31
November / Noviembre	2019	8	16	24	
December / Diciembre	2019	2	10	18	26
January / Enero	2020	3	11	19	27
February / Febrero	2020	4	12	20	28
March / Marzo	2020	7	15	23	31
April / Abril	2020				

Boarding time: 06:00 PM | Disembarking time: 08:30 AM

### Departures / Salidas Punta Arenas - Ushuaia

#### M/V Ventus Australis (4 nights)

September / Septiembre 2019					
October / Octubre	2019	11	19	27	
November / Noviembre	2019	4	12	20	28
December / Diciembre	2019	6	14	22	30
January / Enero	2020	7	15	23	31
February / Febrero	2020	8	16	24	
March / Marzo	2020	3	11	19	27
April / Abril	2020	4			

Boarding time: 06:00 PM | Disembarking time: 08:30 AM

### Departures / Salidas Ushuaia - Punta Arenas

#### M/V Stella Australis (4 nights)

September / Septiembre 2019					25
October / Octubre	2019	3	11	19	27
November / Noviembre	2019	4	12	20	28
December / Diciembre	2019	6	14	22	30
January / Enero	2020	7	15	23	31
February / Febrero	2020	8	16	24	
March / Marzo	2020	3	11	19	27
April / Abril	2020	4			

Boarding time: 06:00 PM | Disembarking time: 11:30 AM

### Departures / Salidas Ushuaia - Punta Arenas

#### M/V Ventus Australis (4 nights)

September / Septiembre 2019					
October / Octubre	2019		15	23	31
November / Noviembre	2019	8	16	24	
December / Diciembre	2019	2	10	18	26
January / Enero	2020	3	11	19	27
February / Febrero	2020	4	12	20	28
March / Marzo	2020	7	15	23	31
April / Abril	2020	8			

Boarding time: 06:00 PM | Disembarking time: 11:30 AM



## Fjords of Tierra del Fuego

Punta Arenas - Ushuaia · 4 nights

M/V Ventus Australis | M/V Stella Australis

Excursions per trip: 5

**Day 1:** Punta Arenas

**Day 2:** Ainsworth Bay - Tuckers Islets\*

**Day 3:** Pía Glacier - Glacier Alley\*\*

**Day 4:** Cape Horn - Wulaia Bay

**Day 5:** Ushuaia

\* In April this excursion is replaced with Brookes Glacier

\*\* Not an excursion



## Patagonian Explorer

Ushuaia - Punta Arenas · 4 nights

M/V Ventus Australis | M/V Stella Australis

Excursions per trip: 7

**Day 1:** Ushuaia

**Day 2:** Cape Horn - Wulaia Bay

**Day 3:** Pía Glacier - Garibaldi Glacier

**Day 4:** Cóndor Glacier - Águila Glacier

**Day 5:** Magdalena Island\* - Punta Arenas

\* In April this excursion is replaced with Marta Island





# M/V Stella Australis - M/V Ventus Australis



Patagonia Dining Room



Darwin Lounge



Yamana Lounge



AAA Double Bed Cabin

**Passenger Capacity** 210  
**Total Cabins** 100

## Cabin Plan

- Standard: 177 sq.ft. / 16,5 m<sup>2</sup>
- Superior: 220 sq.ft. / 20,5 m<sup>2</sup>

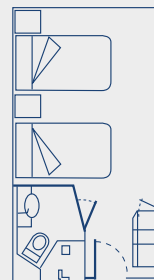

Standard

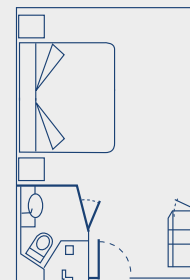

Superior

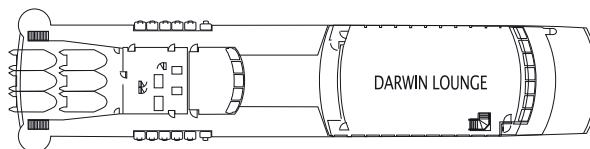

DARWIN DECK

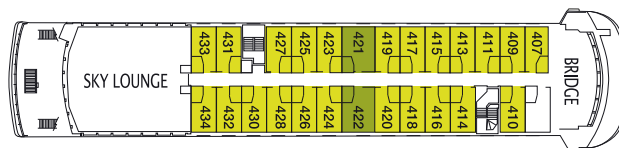

CABO DE HORNOS DECK

- AAA
- AAA SUPERIOR

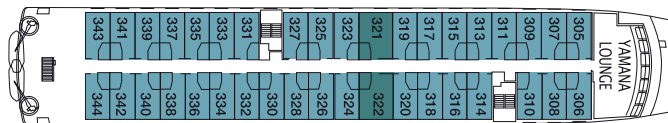

TIERRA DEL FUEGO DECK

- AA
- AA SUPERIOR

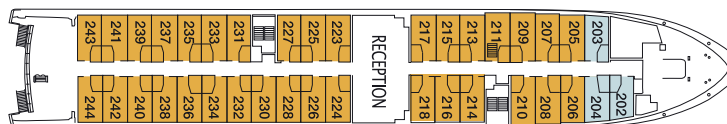

MAGALLANES DECK

- A
- B

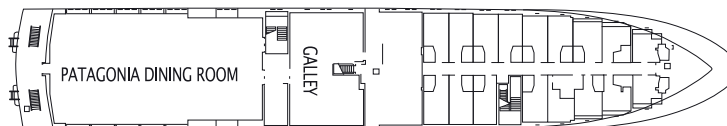

PATAGONIA DECK